

HD 9/50-4 CAGE

This product uses up to 500 bar of pressure to remove even the most stubborn dirt. The robust cage design provides all-round protection and enables safe crane loading. With sack-trolley principle for easy transportation.



Made in Germany



Order no.

1.367-156.0

- 4-pole air-cooled electric motor
- Low-water cut-out (optional)

Technical data

EAN code		4039784731011
Operating pressure	bar / MPa	150 - max. 500 / 15 - max. 50
Flow Rate	l/h	500 - 900
Water feed temperature	°C	max. 60
Fuel		Electric
Motor rating	kW	15
Number of current phases	Ph	3
Voltage	V	400
Frequency	Hz	50
Pump Type		Maximum performance Kärcher crankshaft pump
Weight without accessories	kg	150
Weight (with accessories)	kg	195
Dimensions (L × W × H)	mm	930 × 800 × 920

This machine requires instruction.

Scope of supply

Spray gun: Industrial trigger gun
 Stainless steel spray lance: 700 mm
 Flat jet nozzle

Equipment

High-pressure hose length: 10 m
 High-pressure hose type: Heavy duty
 Safety valve
 Elapsed time counter

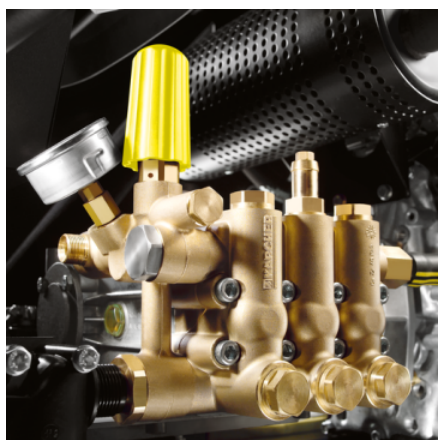

High-performance crankshaft pump

- Reliable and durable Kärcher high-performance crankshaft pump ensures optimal pressure.

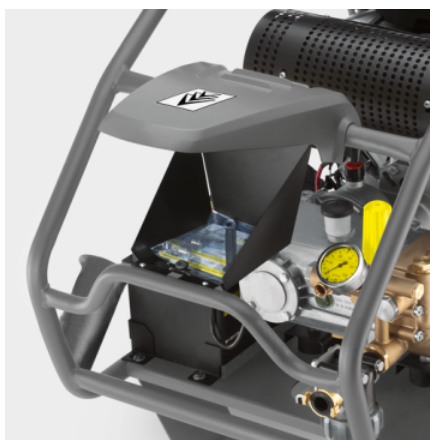

Safe storage

- Accessories and tools are stored in a protected compartment. This means that everything is always in its place.

EQUIPMENT FOR HD 9/50-4 CAGE

1.367-156.0

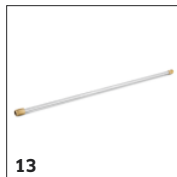

		Order no.	Description	
COLD WATER CAGE MACHINES				
High-pressure hoses				
Pressure hose, 10 m, 640 bar, M22 × 1.5	1	6.391-848.0	650 bar, M 22 × 1.5	■
Pressure hose, 3 m, 640 bar, M22 × 1.5	2	6.391-856.0	650 bar, M 22 × 1.5.	□
Pressure hose, 20 m, 640 bar, M22 × 1.5	3	6.391-857.0		□
Pressure hose, 30 m, 640 bar, M22 × 1.5	4	6.391-020.0	Durable, abrasion-resistant and flexible multi-layer steel-reinforced hose with connection size M 22 × 1.5. Suitable for up to 640 bar working pressure.	□
Pressure hose, 10 m, 620 bar, M22 × 1.5	5	6.391-846.0	650 bar, M 22 × 1.5	□
Pressure hose, 20 m, 620 bar, M22 × 1.5	6	6.391-847.0	650 bar, M 22 × 1.5.	□
Pressure hose, 30 m, 620 bar, M22 × 1.5	7	6.391-019.0	Durable, abrasion-resistant and flexible multi-layer steel-reinforced hose with connection size M 22 × 1.5. Suitable for up to 620 bar working pressure.	□
Lances				
Kärcher industry gun	8	4.775-824.0	650 bar - industrial spray gun with optimised flow. Robustness and durability for professional use. Food-safe and saltwater-resistant materials. Connector for HP hoses M 22 × 1.5.	■
Jet tube				
Spray lance	9	4.760-679.0	With nozzle holder.	■
	10	4.760-653.0		□
Jet pipe complete 1550 mm 65 MPa	11	4.760-675.3		□
Spray lance	12	4.760-677.0		□
Spray lance extension	13	4.760-699.0	Spray lance extension 800 mm, 65 MPa.	□
Add on kits				
ABS protection against water shortage	14	2.641-922.0	For electric motors.	□

■ Included in delivery. □ Available accessories.

EQUIPMENT FOR HD 9/50-4 CAGE

1.367-156.0



		Order no.	Description	
COLD WATER CAGE MACHINES				
Add on kits				
ABS protection against water shortage	15	2.851-028.0	ABS steering rollers.	<input type="checkbox"/>
Couplings and connectors				
Coupling	16	4.403-004.0	For joining and extending HD hoses. Connection 2 × M 22 × 1.5. Material: Stainless steel.	<input type="checkbox"/>
Grease for stainless steel threaded joints	17	6.280-180.0	Grease for stainless steel screw connections.	<input type="checkbox"/>
Pipe cleaning				
Foot valve for pipe cleaning	18	6.470-223.0	Foot valve for convenient and safe use of accessories for effective pipe cleaning.	<input type="checkbox"/>
Pipe cleaning nozzle standard 030 50MPa	19	4.765-013.0	Standard pipe cleaning nozzle for pipe cleaning hoses with G1/4" threaded connection. Nozzle configuration: 3x backward.	<input type="checkbox"/>
Pipe cleaning nozzle Four 030 50MPa	20	4.765-019.0	Quattro pipe cleaning nozzle (500/15) for pipe cleaning hoses with G1/4" threaded connection. The chisel point nozzle configuration is 3x backward and 1x forward.	<input type="checkbox"/>
Pipe cleaning nozzle, Rotor	21	5.763-095.0	Rotor pipe cleaning nozzle for pipe cleaning hoses with G1/4" threaded connection. Nozzle configuration: 3x backward.	<input type="checkbox"/>
Pipe cleaning hose	22	6.392-401.0	Flexible pressure hose (DN 8) for thorough pipe cleaning. 10 m long. Threaded connection for G1/4" nozzle.	<input type="checkbox"/>
	23	6.392-402.0	Flexible pressure hose (DN 8) for thorough pipe cleaning. With threaded connection for G1/4" nozzle and 20 m long.	<input type="checkbox"/>
	24	6.392-403.0	For thorough pipe cleaning: flexible, 30 m long pressure hose with threaded connection for G1/4" nozzle.	<input type="checkbox"/>
Surface Cleaner				
FRI 50 Me 50 MPa	25	2.643-577.0	Surface cleaner for efficient cleaning of surfaces up to 500 bar and hot water cleaning up to 100°C. 4 convenient steering rollers. Specific nozzle kits must be ordered separately.	<input type="checkbox"/>
Nozzle pack 015 FRI 50	26	6.415-044.0	Nozzle kit specifically for FRI 50 Me Surface Cleaner. Nozzle size: 015.	<input type="checkbox"/>
Abrasive blaster				
Required adapter for abrasive blasters	27	5.401-325.0	M 20 × 1 IG to 9/16" UNF AG.	<input type="checkbox"/>
Abrasive sprayer	28	9.872-250.0	Effectively protects against corrosion and at the same time ensures mirror-bright vehicle surfaces: VehiclePro Hot Wax RM 820 Classic from Kärcher for use with high-pressure cleaners at self-service washing stations and in vehicle wash systems. Whether for cars, commercial vehicles or bikes, in hard or soft water - the care wax creates a weather-resistant preservative layer that safely protects paintwork for up to one month. In addition, the wax boasts impressive environmentally friendly properties, because the surfactants it contains are biodegradable in accordance with EEC 648/2004, it is VDA-compliant and, with up to 120 cars treated per litre, very economical to use.	<input type="checkbox"/>

Available accessories.

EQUIPMENT FOR HD 9/50-4 CAGE 1.367-156.0



	Order no.	Description	
COLD WATER CAGE MACHINES			
Abrasive blaster			
Replacement nozzle for abrasive blaster	29	6.025-346.0	Replacement nozzle for abrasive spray head made from boron carbide. Colour blue. <input type="checkbox"/>
F98 nozzle set, 0.60 mm	30	9.886-550.0	<input type="checkbox"/>
F98 nozzle for abrasive blasters	31	6.025-256.0	0.6 mm <input type="checkbox"/>
Suction lance	32	6.025-258.0	For the suction of spray agents. <input type="checkbox"/>
Abrasive material hose	33	6.025-308.0	Abrasive hose. <input type="checkbox"/>
Mounting tool for nozzle set	34	6.025-257.0	For F98 nozzles. <input type="checkbox"/>
Abrasive	35	6.025-309.0	25 kg, 0.5-1.00 mm, garnet sand. <input type="checkbox"/>
	36	6.025-310.0	25 kg, 0.7-1.40 mm, garnet sand. <input type="checkbox"/>
NOZZLES			
Power nozzles			
Flat jet nozzle, 15030	37	5.765-164.0	15° flat jet nozzle 15030 for high-pressure cleaner HD 9/50. Suitable for working pressures of up to 500 bar and 900 l/h (electr., HDS trailer). <input checked="" type="checkbox"/>
Point jet nozzle, 0030	38	5.765-159.0	Point jet nozzle 0030 for high-pressure cleaner HD 9/50. Suitable for working pressures of up to 500 bar and 900 l/h (electr.). <input type="checkbox"/>
Screw nozzle			
Dummy nozzle F21	39	6.025-237.0	F21 screw-on dummy nozzle. Suitable for working pressures of up to 3,000 bar. <input type="checkbox"/>
Round jet nozzle F21, Saphir, 0,7 mm	40	6.025-222.0	Screw-on F21 sapphire round jet nozzle with a diameter of 0.70 mm. Suitable for working pressures of up to 3,000 bar. <input type="checkbox"/>
PROTECTIVE CLOTHING			
HD Overall size M	41	6.547-055.0	<input type="checkbox"/>
HD Overall size L	42	6.547-056.0	<input type="checkbox"/>

■ Included in delivery. □ Available accessories.

EQUIPMENT FOR HD 9/50-4 CAGE

1.367-156.0

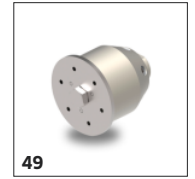
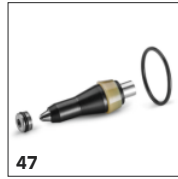
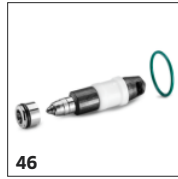

		Order no.	Description	
PROTECTIVE CLOTHING				
HD Overall size XL	43	6.547-057.0		<input type="checkbox"/>
ROTARY NOZZLES				
Single-jet rotary nozzles				
Tool for changing rotor seat	44	6.025-233.0	For F3, F4, F1, F25.	<input type="checkbox"/>
Power Rotary Jet F8 030, 030, 1,05 mm	45	6.415-069.0	500 bar, 1.05 mm, 900 l/h, M 20 × 1, stainless steel.	<input type="checkbox"/>
Repair set Power Rotary Jet F8 030, 030, 1,05 mm	46	6.812-000.0	Repair set for Power Rotary Jet. Suitable for up to 500 bar pressure and water volume of 900 litres/hour. Incl. rotor, fitting and O-ring.	<input type="checkbox"/>
Power rotary jet repair kit F8	47	6.025-437.0	Repair kit for power rotary jet, order no. 6.415-915.0. Suitable for 500 bar pressure and 900 l/h water flow rate. Includes rotor, seat and O-ring (28 × 2).	<input type="checkbox"/>
Multi-jet rotary nozzles				
Nozzle body	48	9.917-677.0	Rotary transmission lead-through with infinitely variable speed control. Includes protective pipe.	<input type="checkbox"/>
Nozzle carrier head TD09	49	9.899-828.0	With the VehiclePro Gloss Dryer Nano RM 832 Classic for excellent drying results after washing passenger cars and commercial vehicles in vehicle wash systems. The effective gloss drying aid based on nanotechnology quickly breaks up the water film over a large area for all water hardnesses, thereby offering excellent drying with high-gloss surfaces. The nanostructured layer formed in the process effectively protects the paint for up to one month. RM 832 Classic is also suitable for use with high-pressure cleaners and enables best results in combination with our Active Foam Wash Nano RM with 816 Classic. It is VDA-compliant and contains neither mineral oils nor mineral hydrocarbons. The surfactants used are biodegradable in accordance with EEC 648/2004. With a yield of up to 50 cars per litre, it is also very economical.	<input type="checkbox"/>

Available accessories.