

## IVR 100/24-2 SC H ACD

With a rated input power of 2.4 kW, the AC-powered IVR 100/24-2 Sc impressively vacuums combustible dusts and fine swarf. For use in non-explosive areas.



Made in Germany



Order no. **9.990-646.0**

- ACD - Applied for Combustible Dust

### Technical data

EAN code		4066529115737
Number of current phases	Ph	1
Voltage	V	220 - 240
Frequency	Hz	50 - 60
Air flow	l/s / m <sup>3</sup> /h	148 / 532
Vacuum	mbar / kPa	230 / 23
Container capacity	l	100
Container material		Steel
Rated input power	kW	2.4
Vacuuming type		Electric
Nominal size		DN 70
Accessory nominal size		DN 50
Sound pressure level	dB(A)	68
Main filter dust class		M
Filter area for main filter	m <sup>2</sup>	1.75
Secondary filter dust class		H
Filter area for secondary filter	m <sup>2</sup>	3
Colour		anthracite
Weight without accessories	kg	124
Weight incl. packaging	kg	124.9
Dimensions (L × W × H)	mm	855 × 760 × 1869

### Equipment

<b>Main filter:</b> Pocket filter
<b>Secondary filter:</b> Cartridge filter
<b>Accessories included with machine:</b> no
<b>Container emptying:</b> Set down chassis



### ACD - Applied for Combustible Dust

- For the safe and economical vacuuming of combustibile dusts.
- Conforms to the IEC 60335-2-69 standard.

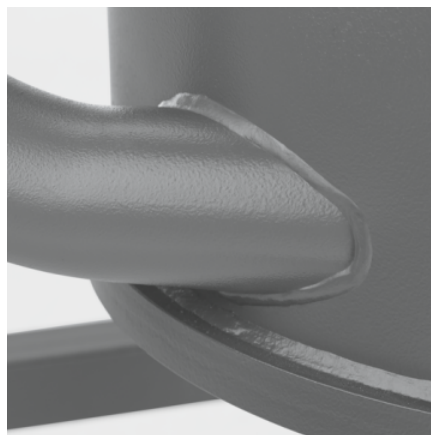

### Particularly robust, particularly flexible

- With practical, movable suction hose port/pipe bend.
- With numerous options for accessory storage.
- Machine and chassis very robust and equipped with high wall thicknesses.



### Fitted with two very quiet fan motors

- For powerful suction power and optimum cleaning performance.
- Fans can be switched on separately for individual suction power as required.
- Very quiet drive head ensures that the cooling air is blown out evenly.

**SUSTAINABILITY INFORMATION FROM IVR 100/24-2 SC H ACD  
9.990-646.0**



**Sustainability features**

Recycled plastics share device	%	29	All plastic parts excluding accessories
--------------------------------	---	----	---

## EQUIPMENT FOR IVR 100/24-2 SC H ACD

### 9.990-646.0



		Order no.	Description	
<b>FILTER T/ NT</b>				
<b>Safety filter sets / sacks</b>				
Safety filter bag, 5 Piece(s), NT 75/1	1	6.904-420.0	For dust-free/low-dust emptying in conjunction with the 4.070-930.0 container, with dust disposal bag, electrically conductive. Checked and approved for dust class H.	■
<b>FILTERS</b>				
<b>Pocket- / Star filters</b>				
Bag filter 1.75 m <sup>2</sup> , Kat. M, antistatic	2	9.981-680.0	Our efficient, acidic VehiclePro Rim Cleaner RM 800 is impressively effective at vehicle cleaning, while at the same time being gentle on the material. It is suitable for self-service washing stations and for use with spray units in commercial vehicle washes, forming an active cleaning foam that quickly and safely removes typical soiling such as brake dust, tyre wear, limescale stains or aggressive deposits of winter road salt. Its gentle properties not only protect the rims of cars and commercial vehicles, but also do not attack uncoated concrete floors or stainless steel wheel arches. The ingredients of the standard cleaner are 90 per cent biodegradable - surfactants contained are in accordance with EEC 648/2004. With a cleaning performance of about 400 rims per litre, the VehiclePro rim cleaner RM 800 is also highly economical and efficient.	■
Pocket filter	3	9.981-681.0	Electroconductive filter cloth for dust class M with 517 mm diameter and 1.75 m <sup>2</sup> filter area.	■
<b>Cartridge filters</b>				
Cartridge filter ø325x205mm, Kat. "H14"	4	9.980-249.0		■
<b>EMPTYING SUPPORTS</b>				
<b>Disposal bags</b>				
Bag disposal PE ø540 mm 100 l 5x	5	9.989-607.0	For dust-free emptying: 5 PE emptying bags with 100 l volume. Diameter: 540 mm.	■
<b>ACCESSORY SETS</b>				
<b>Liquids</b>				
Accessories kit liquid DN50	6	9.990-879.0	Accessory kit DN50 for liquid vacuums: PU hose 3 m (9.989-619.0), handle (9.977-678.0), standard nozzle (9.988-402.0), surface nozzle 120 mm (9.988-119.0).	□
<b>Solid / Dust</b>				
Kit food DN50	7	9.989-941.0	Food accessory kit: PU hose 3 m (9.989-973.0), handle (9.989-899.0), standard nozzle (9.989-844.0), brush (9.989-880.0), reducer (9.989-712.0), adapter (9.993-011.0).	□
Kit overhead cleaning DN50	8	9.989-943.0	Accessory kit DN 50 for overhead cleaning: suction tubes (9.989-921.0/9.993-009.0), handles (9.989-917.0/9.989-919.0), standard nozzle (9.989-844.0), brush (9.989-880.0), adapter (9.993-011.0).	□
Kit solid dust DN50	9	9.989-662.0	Accessory kit DN 50 for industrial vacuum cleaners (solids and dust): EVA hose (9.988-090.0), handle (9.977-678.0), standard nozzle (9.988-402.0), reducer (9.977-772.0).	□
<b>NOZZLES</b>				
<b>Standard nozzles</b>				
Standard nozzle silicon FDA blue DN-F50	10	9.989-841.0		□
Standard nozzle silicon FDA green DN-F50	11	9.989-842.0		□
Standard nozzle silicon FDA red DN-F50	12	9.989-843.0		□
Standard nozzle silicon FDA transparent	13	9.989-844.0		□
Standard nozzle silicon FDA white DN-F50	14	9.989-845.0		□

■ Included in delivery. □ Available accessories.

## EQUIPMENT FOR IVR 100/24-2 SC H ACD 9.990-646.0



	Order no.	Description	
<b>NOZZLES</b>			
<b>Standard nozzles</b>			
Standard nozzle silicon FDA yellow DN-F5	15	9.989-846.0	<input type="checkbox"/>
Standard nozzle PVC DN50	16	9.989-673.0	Electroconductive standard PVC nozzle. DN 50. <input type="checkbox"/>
Nozzle elastic silicon DN52	17	9.988-402.0	<input type="checkbox"/>
Standard nozzle rubber cuttable DN50	18	9.989-675.0	Standard nozzle, electroconductive, made from cuttable rubber. DN 50. <input type="checkbox"/>
Standard aluminium nozzle DN50	19	9.980-749.0	Diagonal nozzle made from anodised aluminium, electroconductive, DN 50. <input type="checkbox"/>
<b>Standard nozzles bendable</b>			
Nozzle, zinc coated, flexible, with rubber tip	20	9.981-421.0	Electroconductive, flexible round nozzle made from galvanised steel, DN 50, with rubber mouthpiece DN 30. <input type="checkbox"/>
<b>Floor nozzles</b>			
Bottom nozzle Edelstahl AISI 316L blue	21	9.989-862.0	<input type="checkbox"/>
Floor nozzle stainless steel AISI 316L g	22	9.989-864.0	<input type="checkbox"/>
Floor nozzle stainless steel AISI 316L r	23	9.989-866.0	<input type="checkbox"/>
Floor nozzle stainless steel AISI 316L t	24	9.989-868.0	<input type="checkbox"/>
Floor nozzle stainless steel AISI 316L w	25	9.989-870.0	<input type="checkbox"/>
Floor nozzle stainless steel AISI 316L y	26	9.989-872.0	<input type="checkbox"/>
Floor nozzle stainless steel AISI 304 40	27	9.989-915.0	<input type="checkbox"/>
Floor nozzle stainless steel 400 mm DN-F	28	9.989-935.0	<input type="checkbox"/>

Available accessories.

## EQUIPMENT FOR IVR 100/24-2 SC H ACD 9.990-646.0



	Order no.	Description		
<b>NOZZLES</b>				
<b>Floor nozzles</b>				
Floor nozzle aluminium 400 mm DN-F50	29	9.989-937.0	<input type="checkbox"/>	
Floor nozzle Alu 370 mm DN50	30	9.989-664.0	Floor nozzle. 370 mm, made from aluminium. DN 50.	<input type="checkbox"/>
Multi-purpose nozzle 370mm el. leit., DN	31	9.987-612.0	Electroconductive multi-purpose floor nozzle. 370 mm wide, DN 50.	<input type="checkbox"/>
Floor nozzle Alu 500 mm DN50	32	9.989-684.0	Floor nozzle, 500 mm, made from aluminium. Electroconductive. DN 50.	<input type="checkbox"/>
Multi-purpose nozzle 370mm el. leit., DN	33	9.988-115.0	Floor nozzle (370 mm) made from stainless steel, electroconductive, DN 50.	<input type="checkbox"/>
<b>Crevice nozzles</b>				
Crevice nozzle stainless steel DN50	34	9.989-283.0	<input type="checkbox"/>	
Crevice nozzle, lightweight plastic	35	9.988-117.0	Electroconductive, flat multi-purpose crevice nozzle made from plastic, DN 52.	<input type="checkbox"/>
Crevice nozzle 25 mm × 120 mm DN50	36	9.981-465.0	Electroconductive crevice nozzle made from sheet steel, DN 50, with 25 mm slot width.	<input type="checkbox"/>
Crevice nozzle slot nozzle V2A AK DN50	37	9.988-123.0	Stainless steel crevice nozzle, DN 50, suitable for use with foods.	<input type="checkbox"/>
<b>Crevice nozzles bendable</b>				
Crevice nozzle nozzle flexible silicone	38	9.989-847.0	<input type="checkbox"/>	
Flexible crevice nozzle 12 mm × 45 mm DN50	39	9.981-424.0	Flexible, electroconductive galvanised crevice nozzle, DN 50, with 13 mm slot width.	<input type="checkbox"/>
Crevice nozzle, zinc coated, flexible	40	9.981-425.0	Flexible and electroconductive crevice nozzle made from galvanised steel with 20 mm slot width, DN 50.	<input type="checkbox"/>
<b>Surface nozzles</b>				
Standard nozzle silicon FDA blue DN-F40	41	9.989-850.0	<input type="checkbox"/>	
	42	9.989-852.0	<input type="checkbox"/>	

Available accessories.

## EQUIPMENT FOR IVR 100/24-2 SC H ACD 9.990-646.0



	Order no.	Description	
<b>NOZZLES</b>			
<b>Surface nozzles</b>			
Standard nozzle silicon FDA blue DN-F40	43	9.989-854.0	<input type="checkbox"/>
	44	9.989-856.0	<input type="checkbox"/>
	45	9.989-858.0	<input type="checkbox"/>
	46	9.989-860.0	<input type="checkbox"/>
Nozzle with connecting piece 90° DN50	47	9.988-119.0	Electroconductive rubber nozzle, angled, DN 50, suitable for use with foods. <input type="checkbox"/>
<b>BRUSHES</b>			
<b>Standard brushes</b>			
Standard brush 40 mm DN50	48	9.981-432.0	Flat brush nozzle DN 50. <input type="checkbox"/>
<b>Pencil brushes</b>			
Brush FDA blue ø 75 mm DN-F50	49	9.989-874.0	<input type="checkbox"/>
Brush FDA green ø 75 mm DN-F50	50	9.989-876.0	<input type="checkbox"/>
Brush FDA red ø 75 mm DN-F50	51	9.989-878.0	<input type="checkbox"/>
Brush FDA white ø 75 mm DN-F50	52	9.989-880.0	<input type="checkbox"/>
Brush FDA yellow ø 75 mm DN-F50	53	9.989-882.0	<input type="checkbox"/>
<b>Surface brushes</b>			
Vacuum brush	54	9.981-912.0	Vacuum brush, 300 mm, with 45° connection, with star screw, horsehair bristles. <input type="checkbox"/>
<b>Cylinder brushes</b>			
Cylinder brush ø 100 mm F-DN50	55	9.989-925.0	<input type="checkbox"/>
Cylinder brush ø 200 mm F-DN50	56	9.989-926.0	<input type="checkbox"/>

Available accessories.

## EQUIPMENT FOR IVR 100/24-2 SC H ACD 9.990-646.0



	Order no.	Description	
<b>HOSES</b>			
<b>PO-Schläuche</b>			
Hose EVA el. ø50mm 3m	57	9.990-924.0	<input type="checkbox"/>
<b>PVC</b>			
Hose PVC DN50 3 m	58	9.989-964.0	<input type="checkbox"/>
Hose PVC DN50 5 m	59	9.989-965.0	<input type="checkbox"/>
Hose PVC DN50 3 m	60	9.989-615.0	Electroconductive PVC hose, DN 50. Temperature-resistant up to 85 °C. Length: 3 m.
Hose PVC DN50 5 m	61	9.989-616.0	Electroconductive PVC hose, DN 50. Temperature-resistant up to 85 °C. Length: 5 m.
<b>EVA</b>			
Hose EVA DN50 3 m	62	9.989-984.0	<input type="checkbox"/>
Hose EVA DN50 5 m	63	9.989-985.0	<input type="checkbox"/>
Extension hose EVA el. DN52 3m	64	9.988-090.0	Electroconductive hose with NW50. Suitable for temperatures up to 65°C. Length: 3 m.
Extension hose EVA el. DN52 5m	65	9.988-091.0	<input type="checkbox"/>
<b>PU</b>			
Hose PU DN50 3 m	66	9.989-968.0	<input type="checkbox"/>
Hose PU DN50 5 m	67	9.989-969.0	<input type="checkbox"/>
Hose PU FDA DN50 3 m	68	9.989-973.0	<input type="checkbox"/>
Hose PU FDA DN50 5 m	69	9.989-974.0	<input type="checkbox"/>
Hose PU DN50 3 m	70	9.989-619.0	Oil-resistant, electroconductive PU hose, DN 50. Suitable for abrasive suction media and temperature-resistant up to 80 °C. Length: 3 m.

Available accessories.

## EQUIPMENT FOR IVR 100/24-2 SC H ACD 9.990-646.0



	Order no.	Description	
<b>HOSES</b>			
<b>PU</b>			
Hose PU DN50 5 m	71	9.989-620.0	Oil-resistant, electroconductive PU hose, DN 50. Suitable for abrasive suction media and temperature-resistant up to 80 °C. Length: 5 m. <input type="checkbox"/>
<b>HANDLES</b>			
Handle stainless steel AISI 304	72	9.989-897.0	<input type="checkbox"/>
Handle straight stainless steel AISI 304	73	9.989-899.0	<input type="checkbox"/>
Hand grip 45°, DN 52 ohne Sterngriff	74	9.977-678.0	Electroconductive and 45° curved handle made from stainless steel. Inner cone DN 50. <input type="checkbox"/>
Hand grip curved stainless steel 45°, IK	75	9.988-111.0	Curved and electroconductive handle made from stainless steel. Angle 45°, inner cone NW 50. <input type="checkbox"/>
<b>SUCTION TUBES</b>			
Suction tube stainless steel AISI 304 DN	76	9.989-913.0	<input type="checkbox"/>
Suction tube el. ø50mm IK50 - AK50	77	9.990-934.0	<input type="checkbox"/>
Extension pipe 850mm DN 50, SBG	78	9.977-531.0	850 mm long extension tube made from steel. Electroconductive and with inner cone DN 50. <input type="checkbox"/>
Hand grip curved stainless steel 45°IK D	79	9.989-035.0	Electrically conductive suction tube (1500 mm) made of aluminium with 50 mm diameter. <input type="checkbox"/>
Extension pipe stainless steel DN50 IK,	80	9.988-114.0	Electroconductive extension tube made from stainless steel. Inner cone NW 50. <input type="checkbox"/>
<b>OTHER ACCESSORIES</b>			
Cable drum with 25 m cable	81	9.982-080.0	AC cable drum with 25 m cable, for fixing in accessories holder 6.415-930.0. <input type="checkbox"/>
<b>ADAPTERS / REDUCERS / DISTRIBUTORS</b>			
<b>Adapter Accessory</b>			
Adapter Food DN-F50	82	9.993-011.0	<input type="checkbox"/>
<b>Reducers</b>			
Reducer DN 70/DN 50 (SBG)	83	9.977-772.0	<input type="checkbox"/>
<b>Expanders</b>			
Expansion DN50 to DN70	84	9.981-921.0	Reducer from external cone DN 50 to internal cone DN 70. Material: Steel. Electroconductive. <input type="checkbox"/>

Available accessories.

## EQUIPMENT FOR IVR 100/24-2 SC H ACD 9.990-646.0



	Order no.	Description	
<b>ADAPTERS / REDUCERS / DISTRIBUTORS</b>			
<b>Distributors</b>			
Y-adapter ID 52 to 2 x ID 42	85 9.981-149.0	Manifold, electroconductive, steel, DN 50/40/40.	<input type="checkbox"/>
<b>PRE-SEPARATORS</b>			
<b>Pre-separators</b>			
Pre-separator station SB 100L	86 9.982-243.0		<input type="checkbox"/>
Pre-separator station	87 9.982-238.0	Mobile pre-separator station with 100 l volume and discharge flap.	<input type="checkbox"/>
Pre-separator tank dust 60 l DN50	88 9.989-688.0		<input type="checkbox"/>
Pre-separator tank 200 l	89 9.989-685.0	Standard drum which complies with the ISO 15750-2 standard.	<input type="checkbox"/>
<b>Pre-separator covers</b>			
Pre-separator lid DN 50, for 200 l drum	90 9.981-659.0	VehiclePro Brush Shampoo RM 811 Classic is suitable for use in vehicle wash systems and commercial vehicle washes. It reliably removes grease, oil, dirt caused by emissions and typical road dirt, and helps the brushes to slide, while also reducing their resoiling rate so they can keep working for longer. In addition, RM 811 Classic can also be used as an active foam and protects the vehicle paintwork. The economical brush shampoo is capable of cleaning up to 100 cars for every litre, and is designed to work with subsequent wax products to prevent streaks from forming on the paintwork. Surfactants contained in the formula are biodegradable according to OECD. What's more, it separates oil and water quickly in the oil separator.	<input type="checkbox"/>
Pre-separator cover Op liquids ø 575 mm DN70	91 9.981-662.0	Pre-separator cover DN 70 for 200 litre standard drum (9.989-685.0).	<input type="checkbox"/>
Pre-separator cover solid materials ø 517 mm DN70	92 9.981-665.0	Pre-separator cover DN 70. Suitable for containers with 517 mm diameter.	<input type="checkbox"/>
Pre-separator cover solid materials ø 575 mm DN70	93 9.981-661.0	Pre-separator cover DN 70 for 200 litre standard drum (9.989-685.0).	<input type="checkbox"/>

Available accessories.